

ATEX II GD -TÜV IT 21 ATEX 001 X
 Pstat : < 500 mbar
 Pstat standard : 100 mbar +/-15% @22°C
 Max vacuum : 50 mbar pour / for Pstat 100 mbar
 Surface / Area: 1385 cm²
 Kst : dp/dt < 500 bar/s
 Kg : dp/dt < 130 bar/s
 Pmax < 12 bar / Pred. max < 1.8 bar
 - Inox 304 / stainless steel 1.4301
 - Inox 316L / stainless steel 1.4404
 - Joint / gasket EPDM Temp: -40...+80° C
 - Joint / gasket SILICONE Temp: -60..+200° C

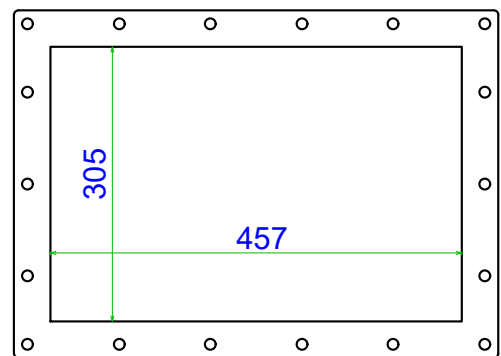

Advise bolts : M10 or 3/8"

| | | | | |
|------------------------------|--------------------------|--------------------------|-------------|-------|
| E | | 07/02/25 | Henry | Eric |
| Ind. | Objet de la modification | Date | Nom | Check |
| STIF SUZHOU | Material: | PoidsWeight: 1,767 kg | Ech: s/e | |
| Int | Plan n°: 57VL_030045_Clt | Date de creation: | | |
| Designation: | | 07/02/25 | | |
| VIGILEX VL-SS 305x457 | | Suivi ATEX: Jim | | |